

STORM STRUCTURE TABLE				
STRUCTURE NAME	STRUCTURE TYPE	RIM ELEVATION	INVERT ELEVATION	
EX-MH-1	MANHOLE (EXISTING)	18.44	13.39	
JB-2	JUNCTION BOX	18.97	13.47 (PIPE)	
			12.47 (SUMP)	
CI-3	CURB INLET	17.78	13.67 (PIPE)	
			8.67 (SUMP)	
CI-4	CURB INLET	17.97	13.92 (PIPE)	
			8.92 (SUMP)	
CI-5	CURB INLET	18.31	13.59 (PIPE)	
			8.59 (SUMP)	
CI-6	CURB INLET	17.49	14.00 (PIPE)	
			9.00 (SUMP)	

STORM PIPE TABLE				
PIPE NAME	SIZE (IN)	LENGTH (LF)	SLOPE	MATERIAL
P-1	30	16	0.50%	HDPE
P-2	24	86	0.30%	HDPE
P-3	18	82	0.30%	HDPE
P-4	24	41	0.30%	HDPE
P-5	18	137	0.30%	HDPE

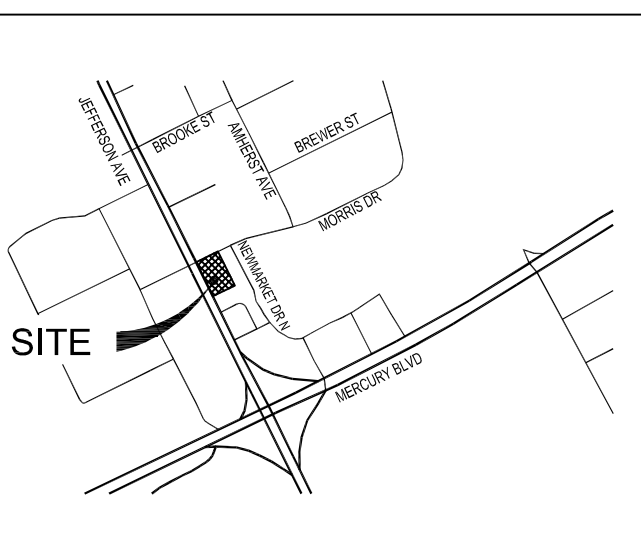
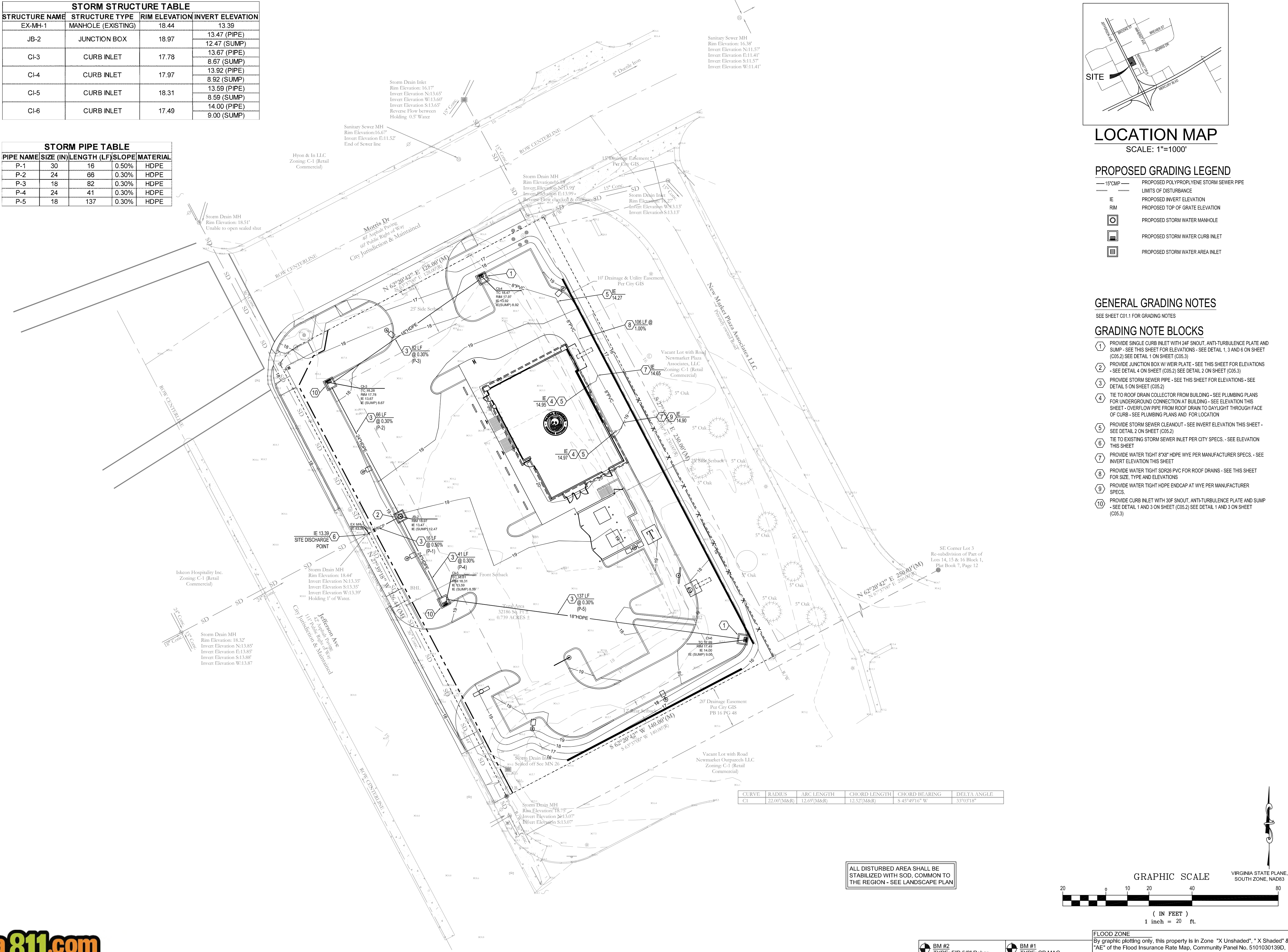

LOCATION MAP  
SCALE: 1"=1000'

PROPOSED GRADING LEGEND	
15" CMP	PROPOSED POLYPROPYLENE STORM SEWER PIPE
IE	LIMITS OF DISTURBANCE
RIM	PROPOSED INVERT ELEVATION
10'	PROPOSED TOP OF GRATE ELEVATION
10'	PROPOSED STORM WATER MANHOLE
10'	PROPOSED STORM WATER CURB INLET
10'	PROPOSED STORM WATER AREA INLET

GENERAL GRADING NOTES  
SEE SHEET C01.1 FOR GRADING NOTES

GRADING NOTE BLOCKS

- 1 PROVIDE SINGLE CURB INLET WITH 24" SNOUT, ANTI-TURBULENCE PLATE AND SUMP - SEE THIS SHEET FOR ELEVATIONS - SEE DETAIL 1, 3 AND 6 ON SHEET (C05.2) SEE DETAIL 1 ON SHEET (C05.3)
- 2 PROVIDE JUNCTION BOX W/ WEIR PLATE - SEE THIS SHEET FOR ELEVATIONS - SEE DETAIL 4 ON SHEET (C05.2) SEE DETAIL 2 ON SHEET (C05.3)
- 3 PROVIDE STORM SEWER PIPE - SEE THIS SHEET FOR ELEVATIONS - SEE DETAIL 5 ON SHEET (C05.2)
- 4 TIE TO ROOF DRAIN COLLECTOR FROM BUILDING - SEE PLUMBING PLANS FOR UNDERGROUND CONNECTION AT BUILDING - SEE ELEVATION THIS SHEET - OVERFLOW PIPE FROM ROOF DRAIN TO DAYLIGHT THROUGH FACE OF CURB - SEE PLUMBING PLANS AND FOR LOCATION
- 5 PROVIDE STORM SEWER CLEANOUT - SEE INVERT ELEVATION THIS SHEET - SEE DETAIL 2 ON SHEET (C05.2)
- 6 TIE TO EXISTING STORM SEWER INLET PER CITY SPECS. - SEE ELEVATION THIS SHEET
- 7 PROVIDE WATER TIGHT 8"X8" HDPE WYE PER MANUFACTURER SPECS. - SEE INVERT ELEVATION THIS SHEET
- 8 PROVIDE WATER TIGHT SDR26 PVC FOR ROOF DRAINS - SEE THIS SHEET FOR SIZE, TYPE AND ELEVATIONS
- 9 PROVIDE WATER TIGHT HDPE ENDCAP AT WYE PER MANUFACTURER SPECS.
- 10 PROVIDE CURB INLET WITH 30" SNOUT, ANTI-TURBULENCE PLATE AND SUMP - SEE DETAIL 1 AND 3 ON SHEET (C05.2) SEE DETAIL 1 AND 3 ON SHEET (C05.3)

CURVE	RADIUS	ARC LENGTH	CHORD LENGTH	CHORD BEARING	DELTA ANGLE
C1	22.00'(M&R)	12.69'(M&R)	12.52'(M&R)	S 45°49'16" W	33°03'18"

ALL DISTURBED AREA SHALL BE STABILIZED WITH SOD, COMMON TO THE REGION - SEE LANDSCAPE PLAN

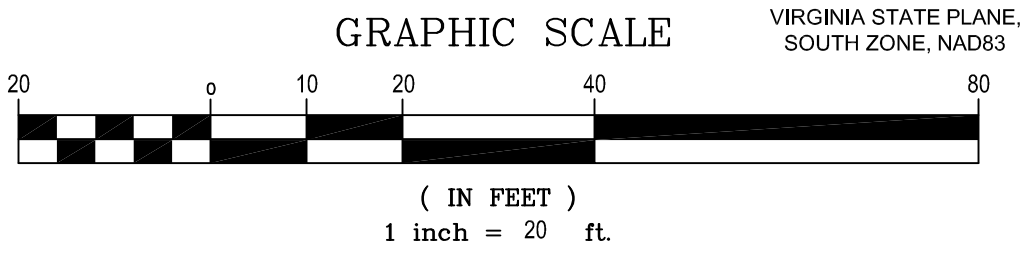

FLOOD ZONE  
By graphic plotting only, this property is in Zone "X Unshaded", "X Shaded" & "AE" of the Flood Insurance Rate Map, Community Panel No. 5101030139D, which bears an effective date of 12/09/2014 and is in a Special Flood Hazard Area, Zone "X-Unshaded" - Area of minimal flood hazard, usually depicted on FIRMs as above the 500-year flood level. Zone X is the area determined to be outside the 500-year flood and protected by levee from 100-year flood.

BM #2  
TYPE: FIP 5/8" Rebar  
NORTHING: 3537921.64  
EASTING: 12082734.63  
ELEVATION: 15.95

BM #1  
TYPE: CP MAG  
NORTHING: 3537960.86  
EASTING: 12082580.68  
ELEVATION: 18.42



PANDA EXPRESS, INC.  
1683 Walnut Grove Ave.  
Rosemead, California  
91770  
Telephone: 626.799.9898  
Facsimile: 626.372.8288

All ideas, designs, arrangement and plans indicated or represented by this drawing are the property of Panda Express Inc. and were created for use on this specific project. None of these ideas, designs, arrangements or plans may be used by or disclosed to any person, firm, or corporation without the written permission of Panda Express Inc.

REVISIONS:

ISSUE DATE:

1	PERMIT/BID SET	02-12-21
2	CITY COMMENTS	08-17-21
3	CITY COMMENTS	10-22-21
4	CITY COMMENTS	12-15-21
5	CITY COMMENTS	01-27-22
	ISSUE FOR BID (DT)	02-04-22

DRAWN BY: LEB

PANDA PROJECT #: S8-21-D8164

PANDA STORE #: D-8164

ARCH PROJECT #: XXXXX-XXX



Civil Engineering Services  
Engineering, Land Planning,  
and Environmental

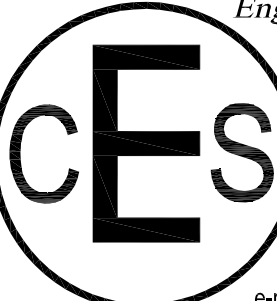

7705 Spicer Farm Lane  
Fairview, Tennessee  
37062  
Phone: (615) 533-0401

e-mail: ray@civilengineeringsservices.net

PANDA EXPRESS

TRUE WARM AND WELCOME  
6104 JEFFERSON AVENUE  
NEWPORT NEWS, VA 23605

DRAINAGE  
PLAN

C05.1

TRUE WARM & WELCOME 2300 R2