

## OWNER'S STATEMENT:

THE UNDERSIGNED HEREBY STATES THAT IT IS THE OWNER OF THE LAND DELINEATED AND EMBRACED WITHIN THE EXTERIOR BOUNDARY LINES ON THE HEREIN EMBODIED PARCEL MAP ENTITLED "PARCEL MAP 10297, CITY OF OAKLAND, COUNTY OF ALAMEDA, STATE OF CALIFORNIA;" THAT SAID OWNER ACQUIRED TITLE TO SAID LAND BY VIRTUE OF THE GRANT DEED RECORDED MAY 07, 2014 UNDER SERIES NO. 2014115164 IN THE OFFICIAL RECORDS OF ALAMEDA COUNTY, STATE OF CALIFORNIA; THAT IT CONSENTS TO THE PREPARATION AND FILING OF THIS PARCEL MAP.

3294 LOUISE STREET, LLC, A CALIFORNIA LIMITED LIABILITY COMPANY.

Kathy Kuhner  
KATHY KUHNER, MANAGING MEMBER

Jan 5, 2015  
DATE:

## OWNER'S ACKNOWLEDGEMENT:

STATE OF CALIFORNIA)

COUNTY OF ALAMEDA)

ON 5 JANUARY 2015 BEFORE ME, T.A. WILLIAMS  
A NOTARY PUBLIC ~~IN AND FOR SAID COUNTY AND STATE~~, PERSONALLY APPEARED  
KATHLEEN TAW KATHY KUHNER

WHO PROVED TO ME ON THE BASIS OF SATISFACTORY EVIDENCE TO BE THE PERSON WHOSE NAME IS SUBSCRIBED TO THE WITHIN INSTRUMENT AND ACKNOWLEDGED TO ME THAT SHE EXECUTED THE SAME IN HER AUTHORIZED CAPACITY, AND THAT BY HER SIGNATURE ON THE INSTRUMENT, THE PERSON, OR THE ENTITY UPON BEHALF OF WHICH THE PERSON ACTED, EXECUTED THE INSTRUMENT.

I CERTIFY UNDER PENALTY OF PERJURY UNDER THE LAWS OF THE STATE OF CALIFORNIA THAT THE FOREGOING PARAGRAPH IS TRUE AND CORRECT.

WITNESS MY HAND.

T.A. Williams  
NOTARY PUBLIC

NAME: T.A. WILLIAMS

MY COMMISSION EXPIRES: 18 MAY 2017

MY COMMISSION NUMBER: 2021801

COUNTY OF PRINCIPAL PLACE OF BUSINESS: ALAMEDA

A NOTARY PUBLIC OR OTHER OFFICER COMPLETING THIS CERTIFICATE VERIFIES ONLY THE IDENTITY OF THE INDIVIDUAL WHO SIGNED THE DOCUMENT TO WHICH THIS CERTIFICATE IS ATTACHED, AND NOT THE TRUTHFULNESS, ACCURACY, OR VALIDITY OF THE DOCUMENT.

## CITY SURVEYOR'S STATEMENT:

I, GILBERT E. HAYES, CITY SURVEYOR, HAVING BEEN AUTHORIZED TO PERFORM THE FUNCTIONS OF THE CITY SURVEYOR OF THE CITY OF OAKLAND, COUNTY OF ALAMEDA, STATE OF CALIFORNIA, DO HEREBY CERTIFY THAT I HAVE EXAMINED THE HEREIN EMBODIED PARCEL MAP ENTITLED "PARCEL MAP 10297, CITY OF OAKLAND, COUNTY OF ALAMEDA, STATE OF CALIFORNIA;" I AM SATISFIED THAT THE PARCEL MAP IS TECHNICALLY CORRECT.

IN WITNESS WHEREOF, I HAVE HEREUNTO SET MY HAND THIS 15<sup>TH</sup>  
DAY OF DECEMBER 2014.

Gilbert E. Hayes  
GILBERT E. HAYES, P.E.S. NO. 4700  
CITY SURVEYOR  
CITY OF OAKLAND, ALAMEDA COUNTY  
STATE OF CALIFORNIA  
LICENSE EXPIRES 9/30/15

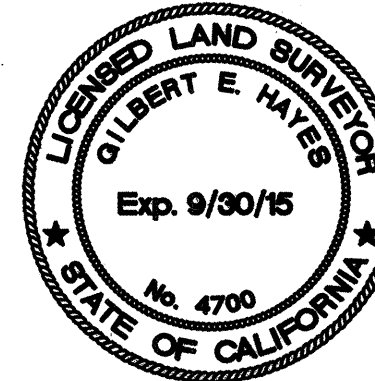

## SURVEYOR'S STATEMENT:

THIS PARCEL MAP WAS PREPARED BY ME OR UNDER MY DIRECTION AND IS BASED UPON A FIELD SURVEY IN CONFORMANCE WITH THE REQUIREMENTS OF THE SUBDIVISION MAP ACT AND LOCAL ORDINANCE AT THE REQUEST OF KATHY KUHNER IN JULY OF 2014. I HEREBY STATE THAT THIS PARCEL MAP SUBSTANTIALLY CONFORMS TO THE APPROVED OR CONDITIONALLY APPROVED TENTATIVE PARCEL MAP, IF ANY. I HEREBY STATE THAT THE MONUMENTS ARE OF THE CHARACTER AND OCCUPY THE POSITIONS INDICATED, AND THE MONUMENTS ARE SUFFICIENT TO ENABLE THE SURVEY TO BE RETRACED.

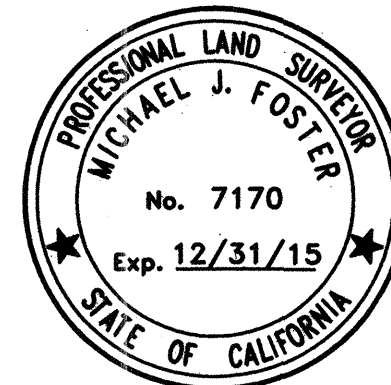

Michael J. Foster  
MICHAEL J. FOSTER, L.S. 7170  
EXPIRATION DATE: DECEMBER 31, 2015

DATE: DEC. 3, 2014

## CITY ENGINEER'S STATEMENT:

I, MICHAEL J. NEARY, CITY ENGINEER, HAVING BEEN AUTHORIZED TO PERFORM THE FUNCTIONS OF THE CITY ENGINEER OF THE CITY OF OAKLAND, DO HEREBY CERTIFY THAT I HAVE EXAMINED THE HEREIN EMBODIED PARCEL MAP ENTITLED "PARCEL MAP 10297, CITY OF OAKLAND, COUNTY OF ALAMEDA, STATE OF CALIFORNIA;" THAT THE SUBDIVISION AS SHOWN UPON SAID PARCEL MAP IS SUBSTANTIALLY THE SAME AS THAT APPEARING ON THE TENTATIVE PARCEL MAP AND ANY APPROVED ALTERATIONS THEREOF; THAT SAID PARCEL MAP COMPLIES WITH ALL PROVISIONS OF THE SUBDIVISION MAP ACT OF THE GOVERNMENT CODE AND THE LOCAL ORDINANCES APPLICABLE AT THE TIME OF THE TENTATIVE PARCEL MAP.

IN WITNESS WHEREOF, I HAVE HEREUNTO SET MY HAND THIS 5<sup>TH</sup>  
DAY OF JANUARY 2015

Michael J. Neary  
MICHAEL J. NEARY, R.C.E. NO. 38547  
CITY ENGINEER  
CITY OF OAKLAND, ALAMEDA COUNTY  
STATE OF CALIFORNIA  
LICENSE EXPIRES: 3/31/15

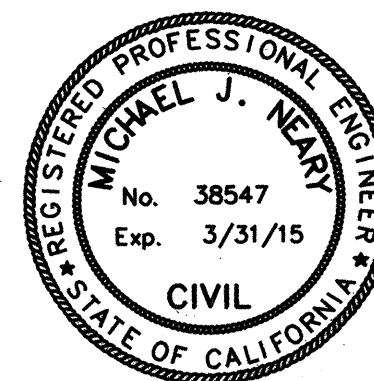

## CLERK OF THE BOARD OF SUPERVISORS STATEMENT:

I, ANIKA CAMPBELL-BELTON, CLERK OF THE BOARD OF SUPERVISORS OF THE COUNTY OF ALAMEDA, STATE OF CALIFORNIA, DO HEREBY STATE THAT CERTIFICATES HAVE BEEN FILED AND DEPOSITS HAVE BEEN MADE IN CONFORMANCE WITH THE REQUIREMENTS OF SECTION 66492 AND 66493 OF THE GOVERNMENT CODE OF THE STATE OF CALIFORNIA.

DATED: 1/8/15

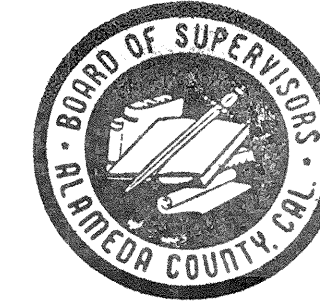

ANIKA CAMPBELL-BELTON, CLERK OF THE BOARD OF SUPERVISORS, COUNTY OF ALAMEDA, STATE OF CALIFORNIA

BY: Anika Campbell-Belton  
DEPUTY CLERK

\$7,557.00  
cc

## RECORDER'S STATEMENT:

FILED THIS 15<sup>TH</sup> DAY OF JANUARY, 2015, AT 8:30 A.M. IN BOOK 328  
OF PARCEL MAPS, AT PAGE 42-43, AT THE REQUEST OF CHICAGO TITLE COMPANY.

\$11.10 2015009769

STEVE MANNING

PATRICK O'CONNOR  
COUNTY RECORDER



BY: Patrick O'Connor  
DEPUTY COUNTY RECORDER

# PARCEL MAP NO. 10297

FOR A 2 LOT SUBDIVISION  
LOT 29, BLOCK 2097, MAP OF THE  
ALDEN TRACT AT TEMESCAL, (17 M. 48)  
CITY OF OAKLAND, ALAMEDA COUNTY, CALIFORNIA  
DECEMBER, 2014

BAY AREA LAND SURVEYING INC.

961 MITCHELL WAY  
EL SOBRANTE, CA 94803  
(510) 223-5167

Parcel Map 10297 Map Bk 328 p. 42