



PANDA EXPRESS, INC.  
1683 Walnut Grove Ave.  
Rosemead, California  
91770  
Telephone: 626.799.9898  
Facsimile: 626.372.8288

All ideas, designs, arrangements and plans indicated or represented by this drawing are the property of Panda Express Inc. and were created for use on this specific project. None of these ideas, designs, arrangements or plans may be used by or disclosed to any person, firm, or corporation without the written permission of Panda Express Inc.

REVISIONS:

Δ	MD STATE HEALTH PR 01	02/24/2023

ISSUE DATE:

LL REVIEW	12-23-22
PERMITS	12-28-22
BID/ CONSTRUCTION SET	08-11-23

DRAWN BY: AB

PANDA PROJECT #: S4-24-D6247  
PANDA STORE #: D6247  
ARCH PROJECT #: JCDT18-0152

I certify that these documents were prepared or approved by me, and that I am a duly licensed architect or engineer under the laws of the State of Maryland, license number \_\_\_\_\_, expiration date \_\_\_\_\_.

**NORR**  
ARCHITECTS PLANNERS PLUMBERS

PANDA EXPRESS  
PANDA HOME 2600  
14 CRANBROOK ROAD  
Cockeysville, MD 21030

**A-100.1**

EGRESS PLAN

PANDA HOME 2600 R3

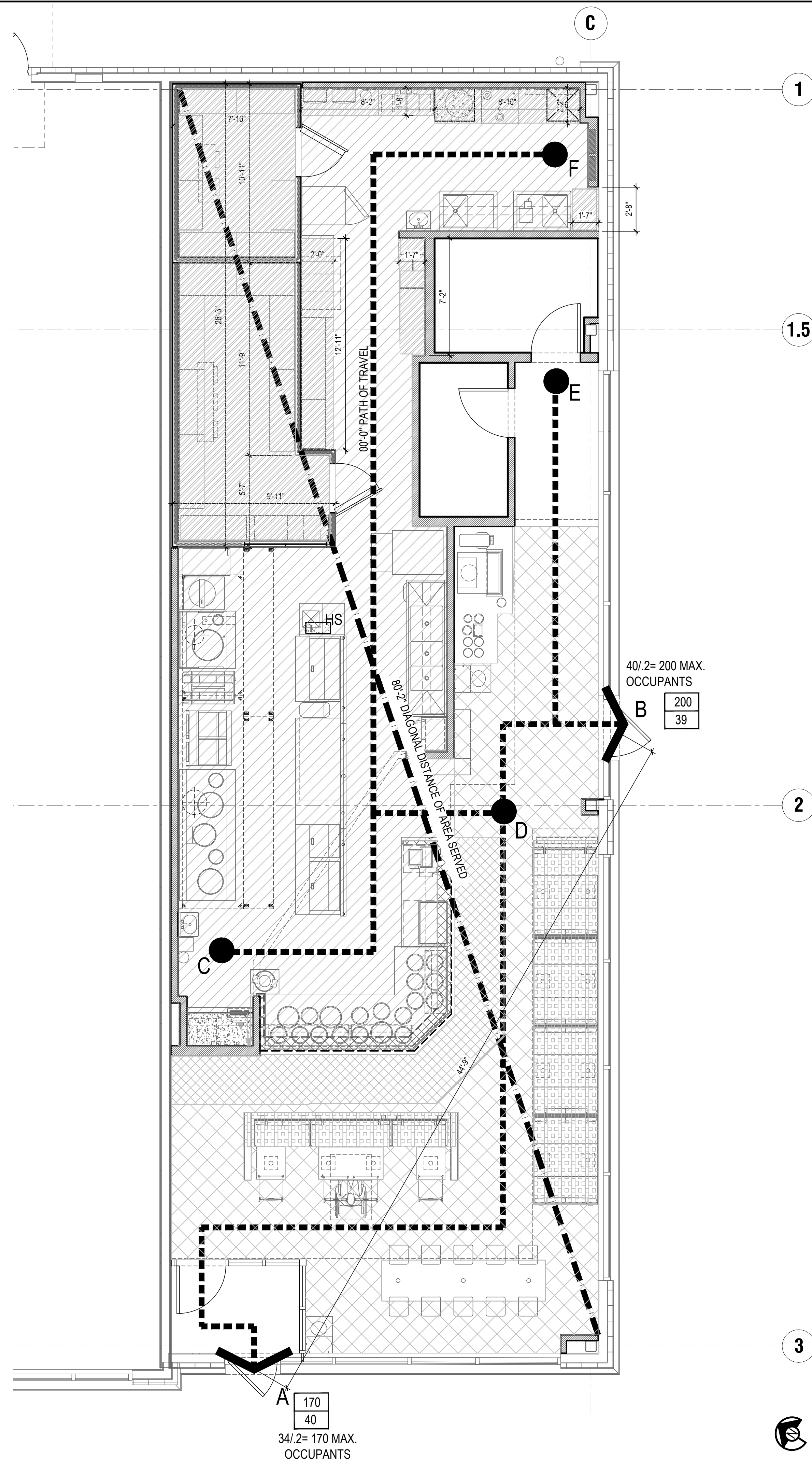

SYMBOL LEGEND	
	EXIT CAPACITY
	ALLOWABLE
	ACTUAL
	MAXIMUM TRAVEL DISTANCE FROM FARTHEST POINT
	ACCESSIBLE ROUTE NUMBER OF SEATS REQUIRED (2) PER 2010 ADA STANDARDS
	SEPARATION OF EXITS = 42'-4" LENGTH > 1/3 (80'-2") DIAGONAL DISTANCE OF AREA SERVED

EGRESS PATH DISTANCES:

F-D 59'-3"  
D-B 12'-4"  
E-B 24'-10"  
C-D 25'-8"  
A-D 55'-6"

COMMON PATH OF TRAVEL	TABLE 1029.8	75 FEET MAX.
EXIT ACCESS TRAVEL DISTANCE	TABLE 1017.2	250 FEET MAX.

OCCUPANCY

	TOILET ROOMS/ CIRCULATION
557 GROSS/0=	0 OCCUPANTS
	KITCHEN
686 GROSS/100=	7 OCCUPANTS
	STORAGE/MECH
282 GROSS/300 =	1 OCCUPANT
	INDOOR DINING STANDING SPACE
96 NET / 5 =	19 OCCUPANTS
	INDOOR DINING - UNCONCENTRATED
432 NET / 15 =	29 OCCUPANTS
	INDOOR DINING - FIXED SEATING
44 LF/2=	22 OCCUPANTS
	BARRIER FREE
	1 OCCUPANTS
TOTAL BUILDING OCCUPANCY COUNT: 79 - OCCUPANTS	

EGRESS PLAN 1

Scale= 1/4" = 1'-0"



BID/CONSTRUCTION SET 08-11-2023