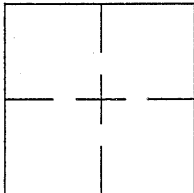

CORNER RECORD

Document Number CR 5686City of OAKLANDCounty of ALAMEDA, CaliforniaBrief Legal Description BRASS DISC MONUMENT LOCATED WITHIN THE INTERSECTION OF BROADWAY
AND 51ST STREET. (88/G)5

CORNER RECORD

Government Corner ☐ Control ☒
 Meander ☐ Property ☐
 Rancho ☐ Other ☐
 Date of Survey 06/11/13

COORDINATES
(Optional)

N. _____
 E. _____
 Zone _____ Datum _____
 Elev. _____

Corner — Left as found. ☒ Found and tagged ☐ Established ☐ Reestablished ☐ Rebuilt ☐

Identification and type of corner found: Evidence used to identify or procedure used to establish of reestablish the corner:
FOUND BRASS DISC MONUMENT LOCATED WITHIN THE INTERSECTION OF BROADWAY AND
51ST STREET.

AS SHOWN ON CITY OF OAKLAND MONUMENT MAP, PAGE 299.

THIS POINT WAS REFERENCED PRIOR TO A CONSTRUCTION PROJECT IN THE VICINITY.

A description of the physical condition of the monument as found and as set or reset: _____

FOUND AND SET POINTS AS SHOWN ON PAGE 2.

THESE TIES ARE FOR THE PURPOSE OF PERPETUATING THE FOUND MONUMENTATION.

NO CLAIM IS MADE AS TO THE RELATIONSHIP OF THE POINTS OR LINES SHOWN HEREON
TO TRUE BOUNDARY LOCATIONS.

SURVEYOR'S STATEMENT

This Corner Record was prepared by me or under my direction in conformance with

the Land Surveyors' Act on JUNE 13, 20 13.

Signed Vincent H. Cunha L.S. Number LS 4520

VINCENT H. CUNHA

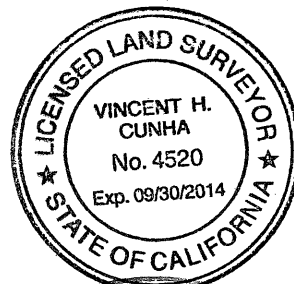

COUNTY SURVEYOR'S STATEMENT

This Corner Record was received 6-14-13 and examined

and filed 8-2-2013

Signed Russell R. Penland Title County Surveyor

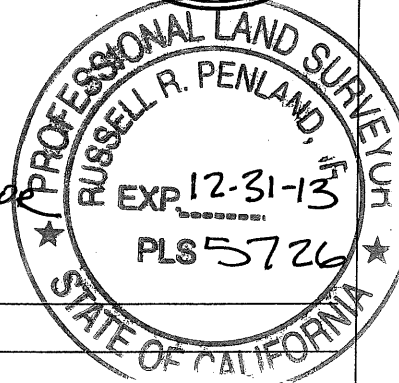

County Surveyor's Comment _____

SCALE: 1"=30'

LEGEND

- FOUND BRASS DISC IN MONUMENT WELL $\left(\frac{88/G}{5}\right)$
- ⊙ FOUND MONUMENT AS NOTED
- ✕ SET CUT CROSS IN CONCRETE

