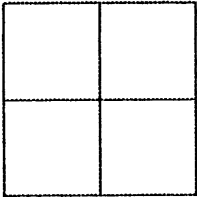

Document Number CR-1072City of BERKELEYCounty of ALAMEDA, CaliforniaBrief Legal Description MONUMENT ON WHITAKER AVE APPROX. 80' NORTHEAST
OF THE INTERSECTION OF STERLING AVE. AT STREET ADDRESS 5**CORNER RECORD**

Government Corner ☐ Control ☐
 Meander ☐ Property ☐
 Rancho ☐ Other ☒
 Date of Survey 8-18-98

COORDINATES
(Optional)

N. _____
 E. _____
 Zone _____ Datum _____
 Elev. _____

Corner — Left as found ☒ Found and tagged ☐ Established ☐ Reestablished ☐ Rebuilt ☐

In conformance with Section 8771 of the Professional Land Surveyors' Act this corner record is being filed to
 ESTABLISH ☒ / REESTABLISH _____ the position of an existing monument PRIOR ☒ / SUBSEQUENT _____
 to street or highway reconstruction.

Identification and type of corner found: Evidence used to identify or procedure used to establish or reestablish the corner:

STANDARD CITY OF BERKELEY STREET MONUMENT, WITHIN ROADWAY.

A description of the physical condition of the monument as found and as set or reset:

MONUMENT WAS REFERENCED;

MONUMENT WILL BE REMOVED DURING CONSTRUCTION AND RESET AFTER

CONSTRUCTION IS COMPLETE.

SURVEYOR'S STATEMENT

This Corner Record was prepared by me or under my direction in conformance with
 the Land Surveyors' Act on SEPTEMBER 7 19 98.

Signed Vincent H. Cunha L.S. Number L5 4520

COUNTY SURVEYOR'S STATEMENT

This Corner Record was received 11-13-1998 and examined

and filed D-69 19 99

Signed Russell R. Penland, Jr.

Title DEPUTY
COUNTY SURVEYOR

County Surveyor's Comment _____

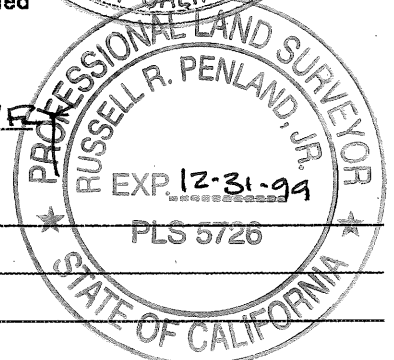
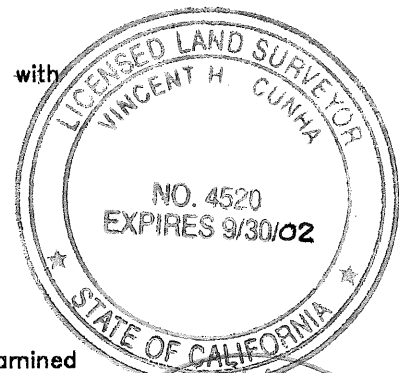

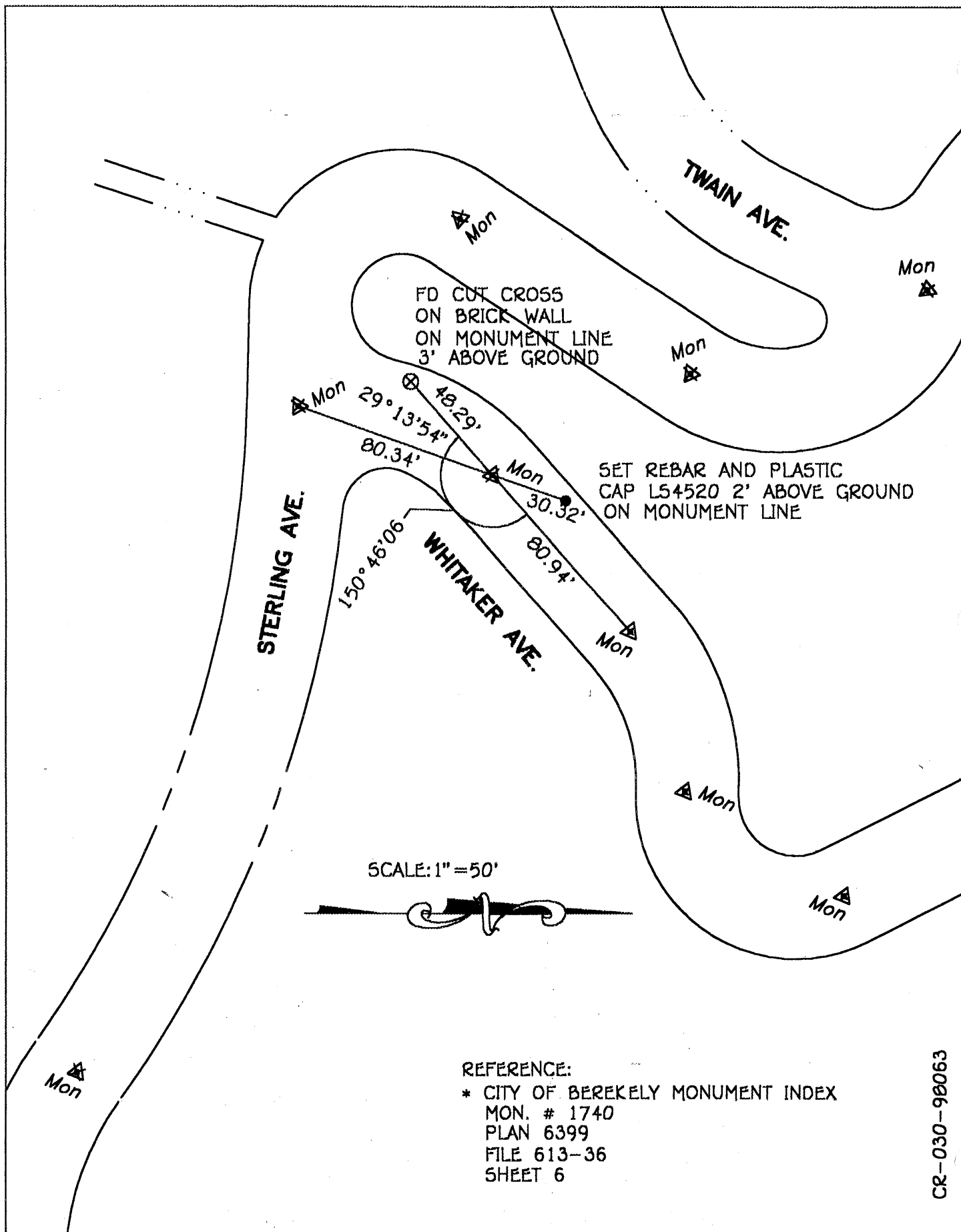

CR-030-98063