

CORNER RECORD

Document Number CR 6774

City of San Leandro County of Alameda, California

Brief Legal Description Parcel "C" Parcel Map No 7440 276/44

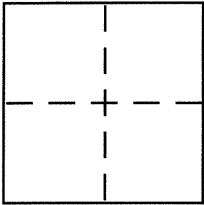

CORNER TYPE

Government Corner ☐ Control ☐
 Meander ☐ Property ☐
 Rancho ☐ Other ☐
 Date of Survey 8 10 08 2014

COORDINATES (Optional)

N. _____
 E. _____
 Zone _____ NAD27 ☐ NAD83 ☐
 NAD83 Epoch _____
 Elev. _____
 Vert. Datum: NGVD29 ☐ NAVD88 ☐
 Meas. Units: Metric ☐ Imperial ☐

Corner – Left as found ☐ Found and tagged ☐ Established ☐ Reestablished ☐ Rebuilt ☐

Identification and type of corner found: Evidence used to identify or procedure used to establish or reestablish the corner:

Found Monuments per Parcel Map No 7440 (276/44)
Set rebar and cap as shown

APN 80A 188 000

16222 LINVIEW DR

A description of the physical condition of the monument as found and as set or reset: _____

SURVEYOR'S STATEMENT

This Corner Record was prepared by me or under my direction in conformance with the Land Surveyor's Act on 10/08/2014

Signed Joseph M. Brajkovich P.L.S. or R.C.E. No. 5254

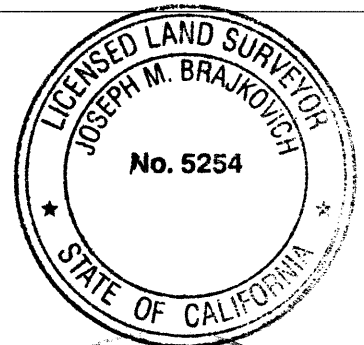

COUNTY SURVEYOR'S STATEMENT

This Corner Record was received 10-20-14

and examined and filed 11-7-14

Signed Russell R. Penland P.L.S. or R.C.E. No. 5726

Title COUNTY SURVEYOR

County Surveyor's Comment _____



EY54EZ

