

		WALL TYPE SCHEDULE							WALL TILE AND GROUT																																													
		<table><tr><td>NO.</td><td>DESCRIPTION</td></tr><tr><td>W1</td><td>EXISTING WALL TO REMAIN (G.C. TO PROTECT IN PLACE)</td></tr><tr><td>W2</td><td>3-5/8" 20GA. METAL STUD @ 16" O.C. - DEMISING WALL</td></tr><tr><td>W3</td><td>3-5/8" 20GA. METAL STUD @ 16" O.C. - WALL FINISHED BY G.C. (SEE WALL FINISH SCHEDULE)</td></tr><tr><td>W4</td><td>NOT USED</td></tr><tr><td>W5</td><td>3-5/8" 20GA. METAL STUD @ 16" O.C. W/ 5/8" TYPE "X" GYP. TAPED & SEALED</td></tr></table>							NO.	DESCRIPTION	W1	EXISTING WALL TO REMAIN (G.C. TO PROTECT IN PLACE)	W2	3-5/8" 20GA. METAL STUD @ 16" O.C. - DEMISING WALL	W3	3-5/8" 20GA. METAL STUD @ 16" O.C. - WALL FINISHED BY G.C. (SEE WALL FINISH SCHEDULE)	W4	NOT USED	W5	3-5/8" 20GA. METAL STUD @ 16" O.C. W/ 5/8" TYPE "X" GYP. TAPED & SEALED	<table><tr><td>NO.</td><td>MANUFACTURER</td><td>DESCRIPTION</td><td>SPECIFICATION</td><td>JOINT</td><td>REMARKS</td><td>GROUT</td><td>TILE CONTACT</td></tr><tr><td>T10</td><td>CREATIVE MATERIALS CORP.</td><td>PORCELAIN TILE (RHYME)</td><td>COLOR: ALMOND NOTE FINISH: MATTE</td><td>1/8"</td><td>WALLS FACING FOOD COURT</td><td>MANUFACTURER: MAPEI PHONE: 800.42.MAPEI WWW.MAPEI.COM STYLE: GROUT # 06 COLOR: HARVEST FINISH: NON-SANDED</td><td>DOUG SALATINO CELL: (518) 281-8264; PHONE: (518) 713-5371 EMAIL: dsalatino@creativematerialscorp.com</td></tr></table>							NO.	MANUFACTURER	DESCRIPTION	SPECIFICATION	JOINT	REMARKS	GROUT	TILE CONTACT	T10	CREATIVE MATERIALS CORP.	PORCELAIN TILE (RHYME)	COLOR: ALMOND NOTE FINISH: MATTE	1/8"	WALLS FACING FOOD COURT	MANUFACTURER: MAPEI PHONE: 800.42.MAPEI WWW.MAPEI.COM STYLE: GROUT # 06 COLOR: HARVEST FINISH: NON-SANDED	DOUG SALATINO CELL: (518) 281-8264; PHONE: (518) 713-5371 EMAIL: dsalatino@creativematerialscorp.com											
NO.	DESCRIPTION																																																					
W1	EXISTING WALL TO REMAIN (G.C. TO PROTECT IN PLACE)																																																					
W2	3-5/8" 20GA. METAL STUD @ 16" O.C. - DEMISING WALL																																																					
W3	3-5/8" 20GA. METAL STUD @ 16" O.C. - WALL FINISHED BY G.C. (SEE WALL FINISH SCHEDULE)																																																					
W4	NOT USED																																																					
W5	3-5/8" 20GA. METAL STUD @ 16" O.C. W/ 5/8" TYPE "X" GYP. TAPED & SEALED																																																					
NO.	MANUFACTURER	DESCRIPTION	SPECIFICATION	JOINT	REMARKS	GROUT	TILE CONTACT																																															
T10	CREATIVE MATERIALS CORP.	PORCELAIN TILE (RHYME)	COLOR: ALMOND NOTE FINISH: MATTE	1/8"	WALLS FACING FOOD COURT	MANUFACTURER: MAPEI PHONE: 800.42.MAPEI WWW.MAPEI.COM STYLE: GROUT # 06 COLOR: HARVEST FINISH: NON-SANDED	DOUG SALATINO CELL: (518) 281-8264; PHONE: (518) 713-5371 EMAIL: dsalatino@creativematerialscorp.com																																															
		DOOR SCHEDULE							TRIM/ CORNER/ COVE BASE																																													
		<table><tr><td>NO.</td><td>DOOR MATERIAL</td><td>SIZE</td><td>FRAME</td><td>FACE/EDGE</td><td>THK.</td><td>CORE</td><td>HDW</td></tr><tr><td>D1</td><td>CECO - REGENT (F)</td><td>3'-6" X 7'-0"</td><td>16 GA. PAINTED BLACK</td><td>18 GA. PAINTED BLACK</td><td>1 3/4"</td><td>HONEYCOMB</td><td>HW-6</td></tr><tr><td>HW-6</td><td>HINGES: MCKINNEY MPB79 4.5X4.5 619</td><td colspan="3">LOCKSET: ROCKWOOD BALL CATCH DUMMY HARDWARE YALE AU YMCL 4701LN X 693X497 619</td><td>STOPS: MCKINNEY WS02 619</td><td>KICK-PLATE: IVES 8400 10" X 28" 619 (BOTH SIDES OF DOOR)</td><td>SILENCERS: ROCKWOOD 608</td></tr></table>							NO.	DOOR MATERIAL	SIZE	FRAME	FACE/EDGE	THK.	CORE	HDW	D1	CECO - REGENT (F)	3'-6" X 7'-0"	16 GA. PAINTED BLACK	18 GA. PAINTED BLACK	1 3/4"	HONEYCOMB	HW-6	HW-6	HINGES: MCKINNEY MPB79 4.5X4.5 619	LOCKSET: ROCKWOOD BALL CATCH DUMMY HARDWARE YALE AU YMCL 4701LN X 693X497 619			STOPS: MCKINNEY WS02 619	KICK-PLATE: IVES 8400 10" X 28" 619 (BOTH SIDES OF DOOR)	SILENCERS: ROCKWOOD 608	<table><tr><td>TR101</td><td>SCHLUTER</td><td>BRUSHED STAINLESS STEEL</td><td>DESIGN LINE - E/M/C DIVIDER TRIM</td><td></td></tr><tr><td>TR102</td><td>SCHLUTER</td><td>BRUSHED STAINLESS STEEL</td><td>QUADEC-E CORNER TRIM</td><td></td></tr><tr><td>TR103</td><td>SCHLUTER</td><td>BRUSHED STAINLESS STEEL</td><td>DILEX-EHK COVE BASE</td><td>AT BASE TRANSITION BETWEEN FLOOR TILE AND WALL TILE (WHERE APPLICABLE)</td></tr></table>							TR101	SCHLUTER	BRUSHED STAINLESS STEEL	DESIGN LINE - E/M/C DIVIDER TRIM		TR102	SCHLUTER	BRUSHED STAINLESS STEEL	QUADEC-E CORNER TRIM		TR103	SCHLUTER	BRUSHED STAINLESS STEEL	DILEX-EHK COVE BASE	AT BASE TRANSITION BETWEEN FLOOR TILE AND WALL TILE (WHERE APPLICABLE)
NO.	DOOR MATERIAL	SIZE	FRAME	FACE/EDGE	THK.	CORE	HDW																																															
D1	CECO - REGENT (F)	3'-6" X 7'-0"	16 GA. PAINTED BLACK	18 GA. PAINTED BLACK	1 3/4"	HONEYCOMB	HW-6																																															
HW-6	HINGES: MCKINNEY MPB79 4.5X4.5 619	LOCKSET: ROCKWOOD BALL CATCH DUMMY HARDWARE YALE AU YMCL 4701LN X 693X497 619			STOPS: MCKINNEY WS02 619	KICK-PLATE: IVES 8400 10" X 28" 619 (BOTH SIDES OF DOOR)	SILENCERS: ROCKWOOD 608																																															
TR101	SCHLUTER	BRUSHED STAINLESS STEEL	DESIGN LINE - E/M/C DIVIDER TRIM																																																			
TR102	SCHLUTER	BRUSHED STAINLESS STEEL	QUADEC-E CORNER TRIM																																																			
TR103	SCHLUTER	BRUSHED STAINLESS STEEL	DILEX-EHK COVE BASE	AT BASE TRANSITION BETWEEN FLOOR TILE AND WALL TILE (WHERE APPLICABLE)																																																		
		NOTE: *ALL INTERIOR DIMENSIONS ARE FROM FACE OF STUD TO FACE OF STUD							PAINT																																													
									<table><tr><td>P100</td><td>SHERWIN-WILLIAMS</td><td>CODE: SW 7016 PROMAR 200, ZERO VOC, (TYPICAL)</td><td>COLOR: MINDFUL GRAY</td><td></td></tr><tr><td></td><td></td><td></td><td></td><td></td></tr></table>							P100	SHERWIN-WILLIAMS	CODE: SW 7016 PROMAR 200, ZERO VOC, (TYPICAL)	COLOR: MINDFUL GRAY																																			
P100	SHERWIN-WILLIAMS	CODE: SW 7016 PROMAR 200, ZERO VOC, (TYPICAL)	COLOR: MINDFUL GRAY																																																			
NOT USED		3	SCHEDULES														2																																					
NOT TO SCALE		A-100	NOT TO SCALE														A-100																																					

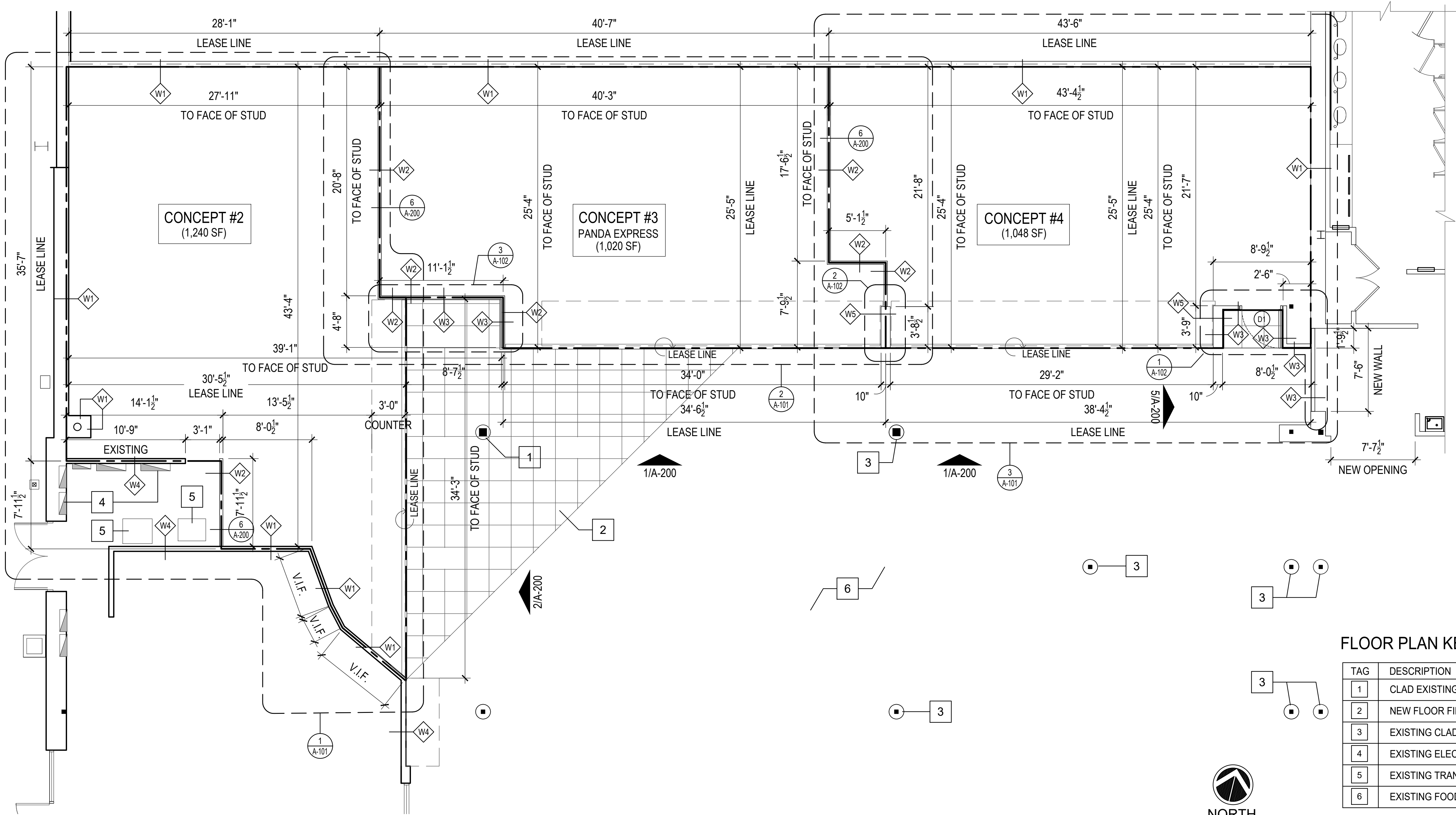

FLOOR PLAN KEYNOTES

TAG	DESCRIPTION
1	CLAD EXISTING COLUMN TO MATCH CLADDING AT COLUMNS
2	NEW FLOOR FINISH TO MATCH EXISTING FLOOR FINISH AT FOOD COURT
3	EXISTING CLADDING AT COLUMNS (G.C. TO PROTECT IN PLACE)
4	EXISTING ELECTRICAL PANELS TO REMAIN (G.C. TO PROTECT IN PLACE)
5	EXISTING TRANSFORMERS (G.C. TO PROTECT IN PLACE)
6	EXISTING FOOD COURT SEATING AREA

OVERALL FOOD COURT FLOOR PLAN (PROPOSED)

SCALE: 3/16" = 1'-0"

1

A-100



NAVY EXCHANGE
SERVICE COMMAND
3280 VIRGINIA BEACH BOULEVARD
VIRGINIA BEACH, VA 23452-5724

THESE DRAWINGS AND SPECIFICATIONS AND IDEAS, DESIGNS AND ARRANGEMENTS REPRESENTED THEREBY ARE AND SHALL REMAIN THE PROPERTY OF _____ AND NO PART THEREOF SHALL BE COPIED, DISCLOSED TO OTHERS OR USED IN CONNECTION WITH ANY WORK OR PROJECT OTHER THAN THE SPECIFIC PROJECT FOR WHICH THEY HAVE BEEN PREPARED AND DEVELOPED WITHOUT THE WRITTEN CONSENT OF GARY WANG & ASSOCIATES. VISUAL CONTACT WITH THESE DRAWINGS AND SPECIFICATIONS SHALL CONSTITUTE CONCLUSIVE EVIDENCE OF THESE RESTRICTIONS. WRITTEN DIMENSIONS ON THESE DRAWINGS SHALL HAVE PRECEDENCE OVER SCALED DIMENSIONS. CONTRACTORS SHALL VERIFY, AND BE RESPONSIBLE FOR ALL DIMENSIONS AND CONDITIONS ON THE JOB, AND THIS OFFICE MUST BE NOTIFIED OF ANY VARIATIONS FROM THE DIMENSIONS AND CONDITIONS SHOWN BY THESE DRAWINGS. SHOP DETAIL MUST BE SUBMITTED TO THIS OFFICE FOR REVIEW BEFORE PROCEEDING WITH THE FABRICATION.

ARCHITECT



GARY WANG
& ASSOCIATES, INC.

1000 Corporate Center Dr., Ste. 550
Monterey Park, CA 91754
TEL: (626) 288-6898 FAX: (626) 768-7101
http://www.garywang.com

STAMP

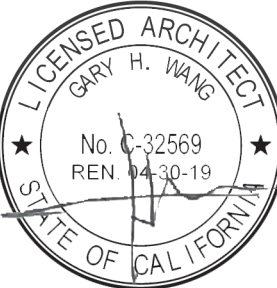

PROJECT NAME/ADDRESS:

NAVY EXCHANGE
FOOD COURT
REMODEL PROJECT

JEB LITTLE CREEK-FORT STORY
BLDG. 3443, NEX FOOD COURT
VIRGINIA BEACH, VA

REVISIONS:

1	JB LITTLE CREEK	2017/06/26
2	JB LITTLE CREEK	2017/08/22
3		
4		
5		
6		

ISSUE DATE:

1ST	10% SUBMITTAL TO NEX	2017/02/22
2ND	35% SUBMITTAL TO NEX	2017/05/26
3RD	95% SUBMITTAL TO NEX	2017/06/26
4TH	100% SUBMITTAL TO NEX	2017/08/30
5TH		
6TH		

JOB NUMBER

DRAWN BY

SHEET CONTENT

OVERALL FOOD COURT
FLOOR PLAN (PROPOSED)

SHEET NO

A-100

BID SET (NOT FOR CONSTRUCTION) ISSUED: 09/06/2017