

CORNER RECORD

Agency Index

BK 128 PG 39

Document Number

CR 13236

City of EDEN TOWNSHIP

County of ALAMEDA, California

Brief Legal Description MONUMENT LOCATED WITHIN ROBEY DR IN FRONT OF 17284 ROBEY DR

CORNER TYPE

COORDINATES (Optional)

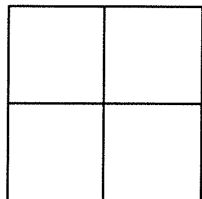

Government Corner ☐ Control ☒
Meander ☐ Property ☐
Rancho ☐ Other ☐

N. _____ E. _____

Elevation _____

Units Metric ☐ U.S. Survey Foot ☐

Horizontal Datum _____

Zone _____ Epoch Date _____

Vertical Datum _____

☐ Complies with Public Resources Code §§8801-8819☐ Complies with Public Resources Code §§8890-8902

Date of Survey 8/6/19

PLS Act Ref: ☐ 8765 (d) ☒ 8771 ☐ 8773 ☐ Other:

Corner/Monument: ☒ Left as found ☐ Established ☐ Rebuilt ☒ Pre-Construction
☐ Found and tagged ☐ Reestablished ☒ Referenced ☐ Post-Construction

Narrative of corner identified and monument as found, set, reset, replaced, or removed:

☐ See sheet #2 for description (s):

FOUND NAIL IN CONCRETE IN MONUMENT WELL

FOUND AND SET POINTS AS SHOWN ON PAGE 2.

THIS POINT WAS REFERENCED PRIOR TO A CONSTRUCTION PROJECT IN THE VICINITY.

THE TIES SHOWN HEREON ARE FOR THE PURPOSE OF PERPETUATING FOUND MONUMENTATION.

NO CLAIM IS MADE AS TO THE RELATIONSHIP OF THE POINTS OR LINES SHOWN HEREON TO TRUE BOUNDARY LOCATION.

SURVEYOR'S STATEMENT

This Corner Record was prepared by me or under my direction in conformance with

the Professional Land Surveyors' Act on AUGUST 7, 2019.

Signed SCOTT V. CUNHA P.L.S. or R.C.E. No. LS 8525

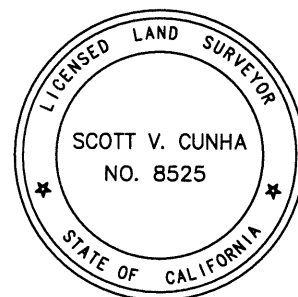

COUNTY SURVEYOR'S STATEMENT

This Corner Record was received AUG 07 2019,

and examined and filed NOV 18 2019.

Signed D. Ian Wilson P.L.S. or R.C.E. No. 7010

Title ALAMEDA COUNTY SURVEYOR

County Surveyor's Comment

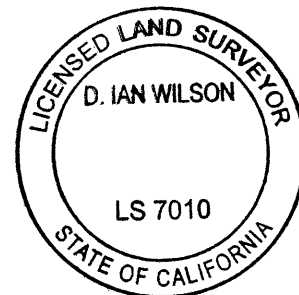

SPEC-2377-Pre

SCALE: 1"=30'

LEGEND

- FOUND NAIL IN CONCRETE IN MONUMENT WELL
- ⊗ SET CUT CROSS IN CONCRETE VALLEY GUTTER
- ⊗ SET MAG AND WASHER STAMPED "CEI RP" IN DRIVEWAY
- ✕ SET CUT CROSS IN DRIVEWAY

(19592) REFERENCE STREET ADDRESS

